FEATURES

- Contacts are formed from the rolled surface of material stock
- Contacts are protected from damage
- High temperature insulator is IR reflow compatible
- SMT Retention clips and Positioning posts are optional
- Can be automatic or manually placed
- SMT solder joints are easy to inspect and repair
- Mated heights of 4, 5, 6, 7 and 8mm
- RoHS compliance

ORDER CODE
DG01



- Plating of contact area
Omit : Au 0.05 μ m (Standard)
- Packaging style
0 : Embossed tape (Tape&Reel)
1 : Tube *Without clips type only
- SMT Retention clips
0 : Without clips
1 : With clips
(Embossed tape/Tape & Reel only)
- Positioning posts
0 : Without posts
1 : With posts
- Stacked height
Plug
2 : For mating height of 4, 5, 6mm
4 : For mating height of 6, 7, 8mm
Receptacle
2 : For mating height of 4, 6mm
3 : For mating height of 5, 7mm
4 : For mating height of 6, 8mm
- Number of contacts
040 : 40 pin 050 : 50 pin
060 : 60 pin 080 : 80 pin
100 : 100 pin 120 : 120 pin
140 : 140 pin 160 : 160 pin
- Connector type
MS : Plug (Male)
FS : Receptacle (Female)
- Series name

SPECIFICATIONS

- Insulator : Plug ; Glass-filled LCP (UL 94V-0), White
Receptacle ; Glass-filled Nylon 46 (UL 94V-0), White
- Contact material : Copper alloy
- Contact plating : 0.05 μ m min. Gold over Nickel
- Current rating : 0.3A per contact
- Contact resistance : 50m Ω max.
- Dielectric withstanding voltage : 200V AC for 1 minute
- Insulation resistance : 1,000M Ω min. at 250 V DC
- Operating temperature : -55°C to +85°C

* Tube (orders accepted 500 pcs. min.) and Embossed tape (Tape&Reel, orders accepted in 500 psc. increments) packaging is available.

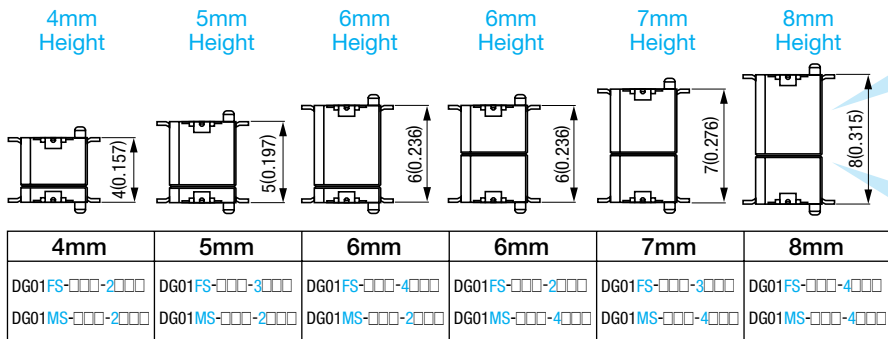
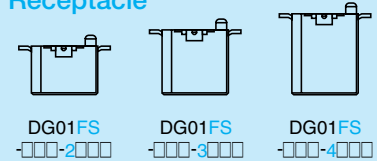
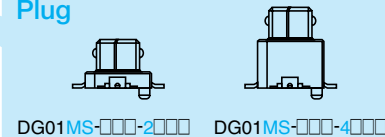
* Please contact your local sales office for orders less than 500 pcs. or regarding automatic placement.

STACKED MATING COMBINA

Receptacle

Plug

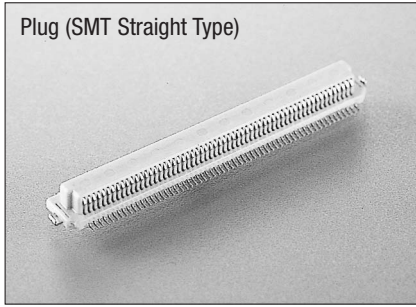
DG01MS-□□□-2□□□ (Plug, For 4, 5 and 6 mm stacked height)

Plug (SMT Straight Type)



Unit:mm(inch)

X-X' Cross Section

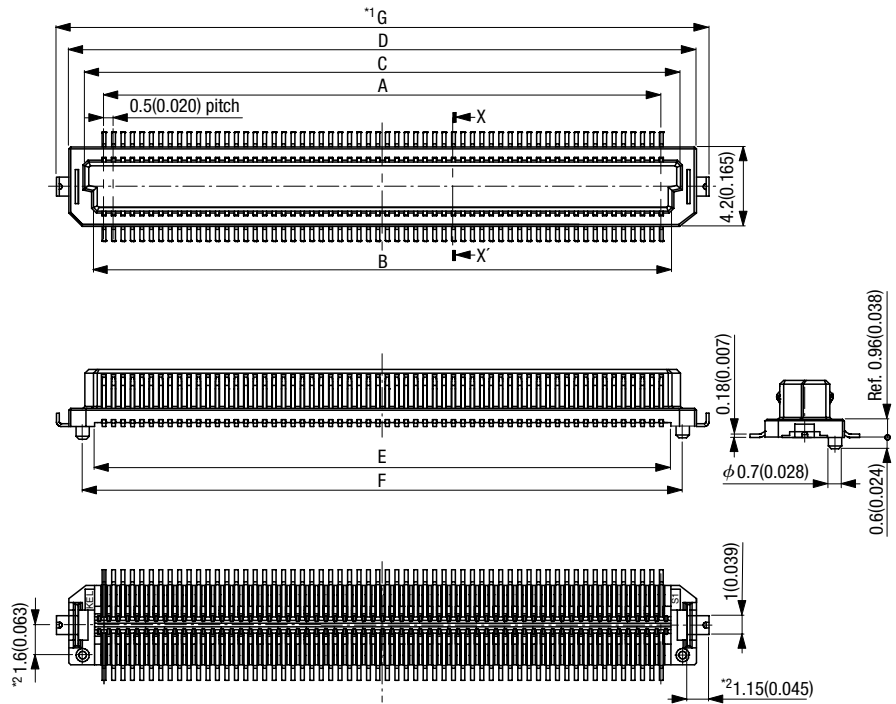
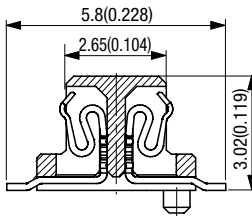

Printed Circuit Board Layout (Component Side View)

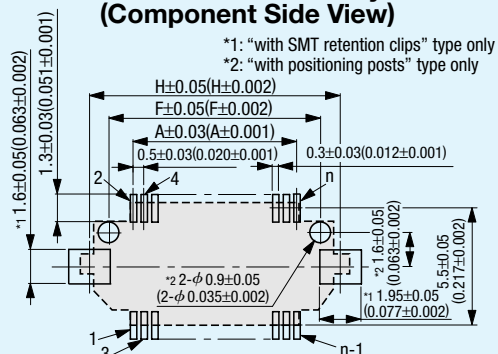

"n" is number of contacts.

Product Table / Dimensions

No. of contacts	Part Number	A	B	C	D	E	F	G	H
40	DG01MS-040-2□□□	9.50 (0.374)	10.62 (0.418)	11.52 (0.454)	13.22 (0.520)	10.50 (0.413)	11.76 (0.463)	14.54 (0.572)	13.59 (0.535)
50	DG01MS-050-2□□□	12.00 (0.472)	13.12 (0.517)	14.02 (0.552)	15.72 (0.619)	13.00 (0.512)	14.26 (0.561)	17.04 (0.671)	16.09 (0.633)
60	DG01MS-060-2□□□	14.50 (0.571)	15.62 (0.615)	16.52 (0.650)	18.22 (0.717)	15.50 (0.610)	16.76 (0.660)	19.54 (0.769)	18.59 (0.732)
80	DG01MS-080-2□□□	19.50 (0.768)	20.62 (0.812)	21.52 (0.847)	23.22 (0.914)	20.50 (0.807)	21.76 (0.857)	24.54 (0.966)	23.59 (0.929)
100	DG01MS-100-2□□□	24.50 (0.965)	25.62 (1.009)	26.52 (1.044)	28.22 (1.111)	25.50 (1.004)	26.76 (1.054)	29.54 (1.163)	28.59 (1.126)
120	DG01MS-120-2□□□	29.50 (1.161)	30.62 (1.206)	31.52 (1.241)	33.22 (1.308)	30.50 (1.201)	31.76 (1.250)	34.54 (1.360)	33.59 (1.322)
140	DG01MS-140-2□□□	34.50 (1.358)	35.62 (1.402)	36.52 (1.438)	38.22 (1.505)	35.50 (1.398)	36.76 (1.447)	39.54 (1.557)	38.59 (1.519)
160	DG01MS-160-2□□□	39.50 (1.555)	40.62 (1.599)	41.52 (1.635)	43.22 (1.702)	40.50 (1.594)	41.76 (1.644)	44.54 (1.754)	43.59 (1.716)

DG01MS-□□□-4□□□ (Plug, For 6, 7 and 8 mm stacked height)

Plug (SMT Straight Type)

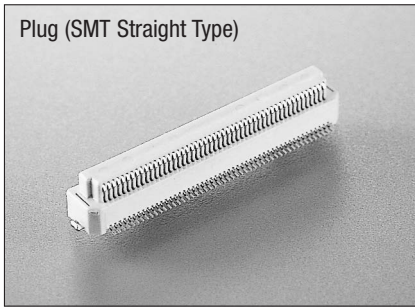

Unit:mm(inch)

X-X' Cross Section

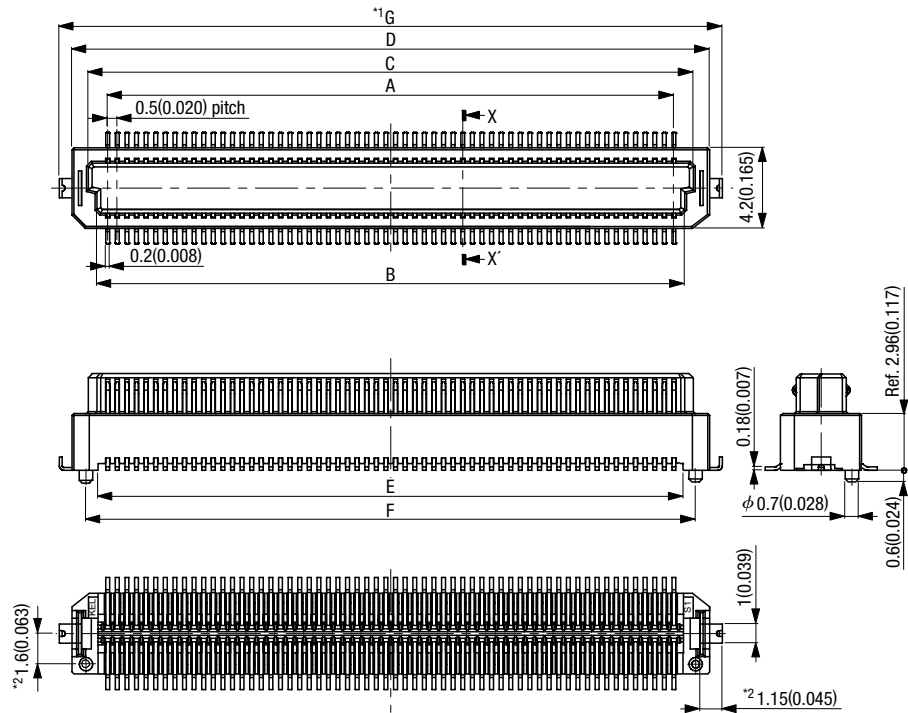
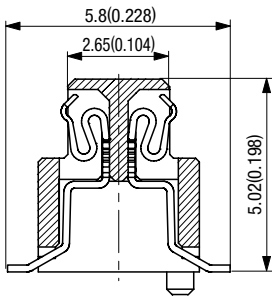

**Printed Circuit Board Layout
(Component Side View)**

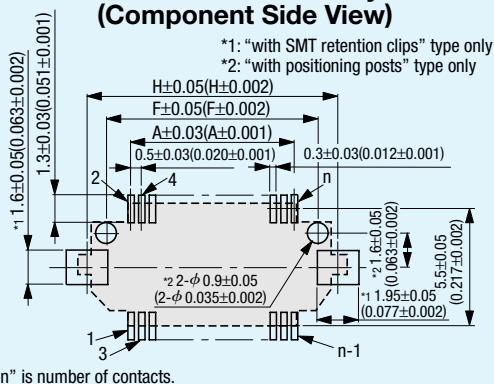

Product Table / Dimensions

No. of contacts	Part Number	A	B	C	D	E	F	G	H
40	DG01MS-040-4□□□	9.50 (0.374)	10.62 (0.418)	11.52 (0.454)	13.22 (0.520)	10.50 (0.413)	11.76 (0.463)	14.54 (0.572)	13.59 (0.535)
50	DG01MS-050-4□□□	12.00 (0.472)	13.12 (0.517)	14.02 (0.552)	15.72 (0.619)	13.00 (0.512)	14.26 (0.561)	17.04 (0.671)	16.09 (0.633)
60	DG01MS-060-4□□□	14.50 (0.571)	15.62 (0.615)	16.52 (0.650)	18.22 (0.717)	15.50 (0.610)	16.76 (0.660)	19.54 (0.769)	18.59 (0.732)
80	DG01MS-080-4□□□	19.50 (0.768)	20.62 (0.812)	21.52 (0.847)	23.22 (0.914)	20.50 (0.807)	21.76 (0.857)	24.54 (0.966)	23.59 (0.929)
100	DG01MS-100-4□□□	24.50 (0.965)	25.62 (1.009)	26.52 (1.044)	28.22 (1.111)	25.50 (1.004)	26.76 (1.054)	29.54 (1.163)	28.59 (1.126)
120	DG01MS-120-4□□□	29.50 (1.161)	30.62 (1.206)	31.52 (1.241)	33.22 (1.308)	30.50 (1.201)	31.76 (1.250)	34.54 (1.360)	33.59 (1.322)
140	DG01MS-140-4□□□	34.50 (1.358)	35.62 (1.402)	36.52 (1.438)	38.22 (1.505)	35.50 (1.398)	36.76 (1.447)	39.54 (1.557)	38.59 (1.519)
160	DG01MS-160-4□□□	39.50 (1.555)	40.62 (1.599)	41.52 (1.635)	43.22 (1.702)	40.50 (1.594)	41.76 (1.644)	44.54 (1.754)	43.59 (1.716)

DG01FS-□□□-2□□□ (Receptacle, For 4 and 6 mm stacked height)

Receptacle (SMT Straight Type)

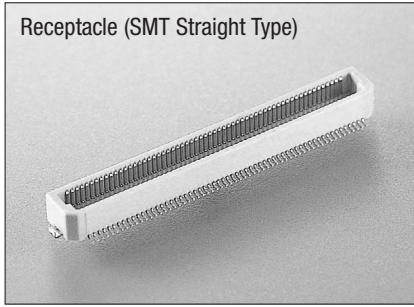

Unit:mm(inch)

X-X' Cross Section

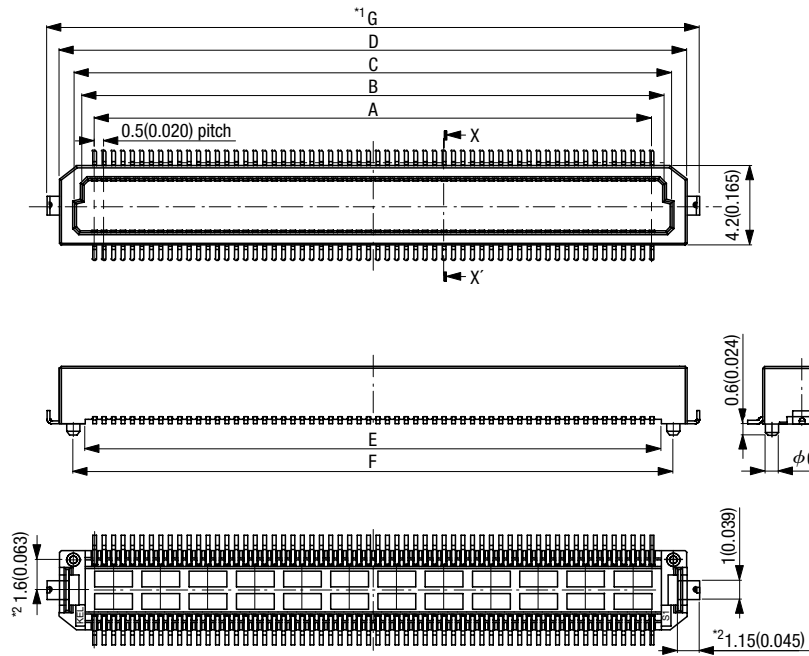
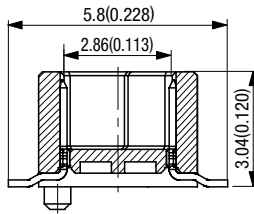

Printed Circuit Board Layout
(Component Side View)

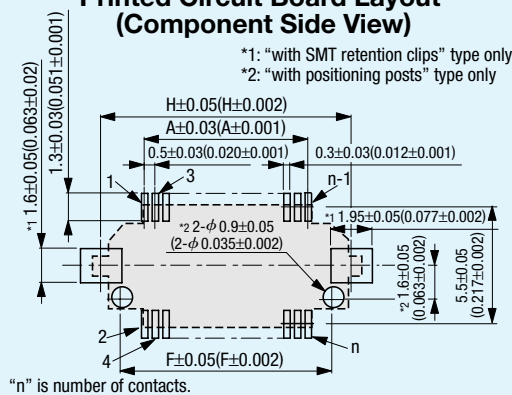

Product Table / Dimensions

No. of contacts	Part Number	A	B	C	D	E	F	G	H
40	DG01FS-040-2□□□	9.50 (0.374)	10.82 (0.426)	11.62 (0.457)	13.22 (0.520)	10.50 (0.413)	11.76 (0.463)	14.54 (0.572)	13.59 (0.535)
50	DG01FS-050-2□□□	12.00 (0.472)	13.32 (0.524)	14.12 (0.556)	15.72 (0.619)	13.00 (0.512)	14.26 (0.561)	17.04 (0.671)	16.09 (0.633)
60	DG01FS-060-2□□□	14.50 (0.571)	15.82 (0.623)	16.62 (0.654)	18.22 (0.717)	15.50 (0.610)	16.76 (0.660)	19.54 (0.769)	18.59 (0.732)
80	DG01FS-080-2□□□	19.50 (0.768)	20.82 (0.820)	21.62 (0.851)	23.22 (0.914)	20.50 (0.807)	21.76 (0.857)	24.54 (0.966)	23.59 (0.929)
100	DG01FS-100-2□□□	24.50 (0.965)	25.82 (1.017)	26.62 (1.048)	28.22 (1.111)	25.50 (1.004)	26.76 (1.054)	29.54 (1.163)	28.59 (1.126)
120	DG01FS-120-2□□□	29.50 (1.161)	30.82 (1.213)	31.62 (1.245)	33.22 (1.308)	30.50 (1.201)	31.76 (1.250)	34.54 (1.360)	33.59 (1.322)
140	DG01FS-140-2□□□	34.50 (1.358)	35.82 (1.410)	36.62 (1.442)	38.22 (1.505)	35.50 (1.398)	36.76 (1.447)	39.54 (1.557)	38.59 (1.519)
160	DG01FS-160-2□□□	39.50 (1.555)	40.82 (1.607)	41.62 (1.639)	43.22 (1.702)	40.50 (1.594)	41.76 (1.644)	44.54 (1.754)	43.59 (1.716)

DG01FS-□□□-3□□□ (Receptacle, For 5 and 7 mm stacked height)

Unit:mm(inch)

Receptacle (SMT Straight Type)

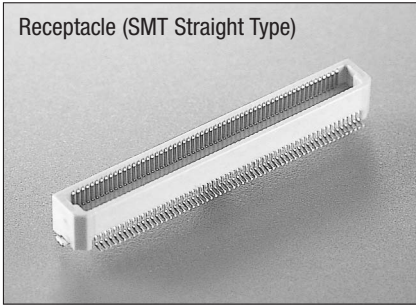

X-X' Cross Section

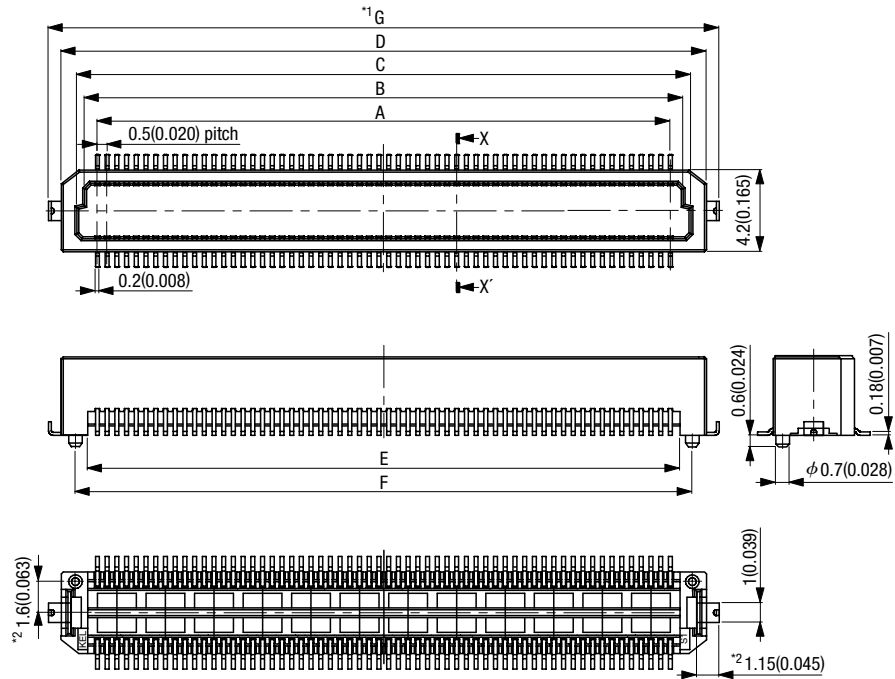
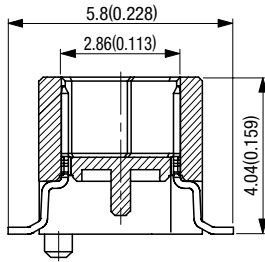

Printed Circuit Board Layout (Component Side View)

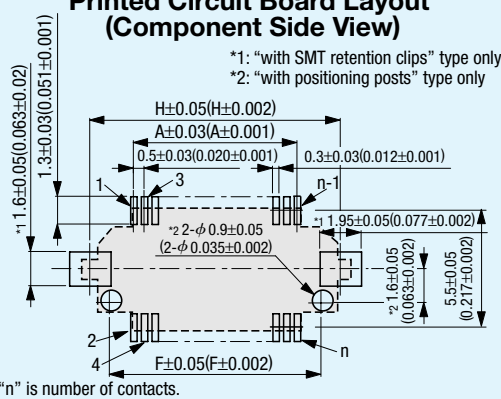

Product Table / Dimensions

No. of contacts	Part Number	A	B	C	D	E	F	G	H
40	DG01FS-040-3□□□	9.50 (0.374)	10.82 (0.426)	11.62 (0.457)	13.22 (0.520)	10.50 (0.413)	11.76 (0.463)	14.54 (0.572)	13.59 (0.535)
50	DG01FS-050-3□□□	12.00 (0.472)	13.32 (0.524)	14.12 (0.556)	15.72 (0.619)	13.00 (0.512)	14.26 (0.561)	17.04 (0.671)	16.09 (0.633)
60	DG01FS-060-3□□□	14.50 (0.571)	15.82 (0.623)	16.62 (0.654)	18.22 (0.717)	15.50 (0.610)	16.76 (0.660)	19.54 (0.769)	18.59 (0.732)
80	DG01FS-080-3□□□	19.50 (0.768)	20.82 (0.820)	21.62 (0.851)	23.22 (0.914)	20.50 (0.807)	21.76 (0.857)	24.54 (0.966)	23.59 (0.929)
100	DG01FS-100-3□□□	24.50 (0.965)	25.82 (1.017)	26.62 (1.048)	28.22 (1.111)	25.50 (1.004)	26.76 (1.054)	29.54 (1.163)	28.59 (1.126)
120	DG01FS-120-3□□□	29.50 (1.161)	30.82 (1.213)	31.62 (1.245)	33.22 (1.308)	30.50 (1.201)	31.76 (1.250)	34.54 (1.360)	33.59 (1.322)
140	DG01FS-140-3□□□	34.50 (1.358)	35.82 (1.410)	36.62 (1.442)	38.22 (1.505)	35.50 (1.398)	36.76 (1.447)	39.54 (1.557)	38.59 (1.519)
160	DG01FS-160-3□□□	39.50 (1.555)	40.82 (1.607)	41.62 (1.639)	43.22 (1.702)	40.50 (1.594)	41.76 (1.644)	44.54 (1.754)	43.59 (1.716)

DG01FS-□□□-4□□□ (Receptacle, For 6 and 8 mm stacked height)

Receptacle (SMT Straight Type)

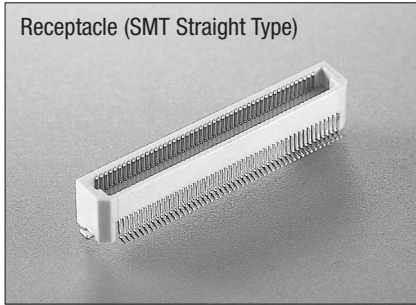

Unit:mm(inch)

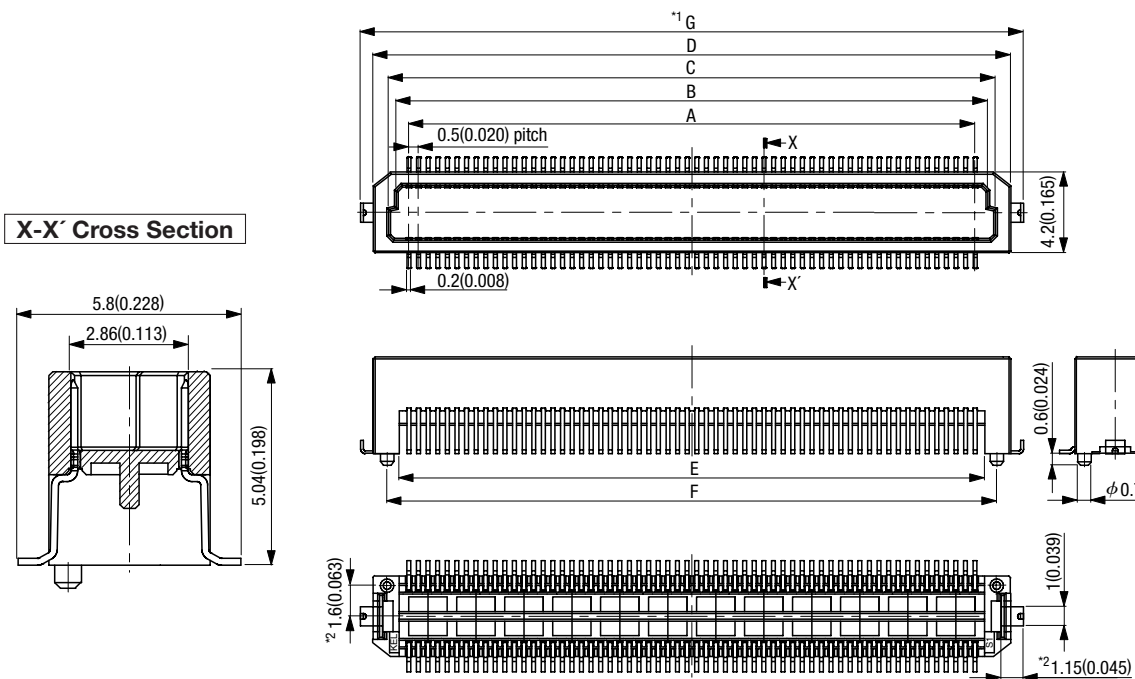

**Printed Circuit Board Layout
(Component Side View)**

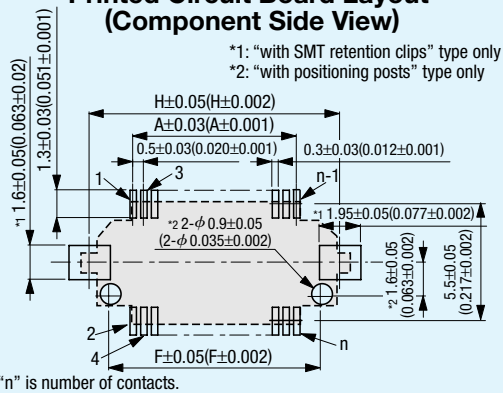

■ Product Table / Dimensions

No. of contacts	Part Number	A	B	C	D	E	F	G	H
40	DG01FS-040-4□□□	9.50 (0.374)	10.82 (0.426)	11.62 (0.457)	13.22 (0.520)	10.50 (0.413)	11.76 (0.463)	14.54 (0.572)	13.59 (0.535)
50	DG01FS-050-4□□□	12.00 (0.472)	13.32 (0.524)	14.12 (0.556)	15.72 (0.619)	13.00 (0.512)	14.26 (0.561)	17.04 (0.671)	16.09 (0.633)
60	DG01FS-060-4□□□	14.50 (0.571)	15.82 (0.623)	16.62 (0.654)	18.22 (0.717)	15.50 (0.610)	16.76 (0.660)	19.54 (0.769)	18.59 (0.732)
80	DG01FS-080-4□□□	19.50 (0.768)	20.82 (0.820)	21.62 (0.851)	23.22 (0.914)	20.50 (0.807)	21.76 (0.857)	24.54 (0.966)	23.59 (0.929)
100	DG01FS-100-4□□□	24.50 (0.965)	25.82 (1.017)	26.62 (1.048)	28.22 (1.111)	25.50 (1.004)	26.76 (1.054)	29.54 (1.163)	28.59 (1.126)
120	DG01FS-120-4□□□	29.50 (1.161)	30.82 (1.213)	31.62 (1.245)	33.22 (1.308)	30.50 (1.201)	31.76 (1.250)	34.54 (1.360)	33.59 (1.322)
140	DG01FS-140-4□□□	34.50 (1.358)	35.82 (1.410)	36.62 (1.442)	38.22 (1.505)	35.50 (1.398)	36.76 (1.447)	39.54 (1.557)	38.59 (1.519)
160	DG01FS-160-4□□□	39.50 (1.555)	40.82 (1.607)	41.62 (1.639)	43.22 (1.702)	40.50 (1.594)	41.76 (1.644)	44.54 (1.754)	43.59 (1.716)

Embossed Tape Packaging Specification

Unit:mm(inch)

Carrier tape

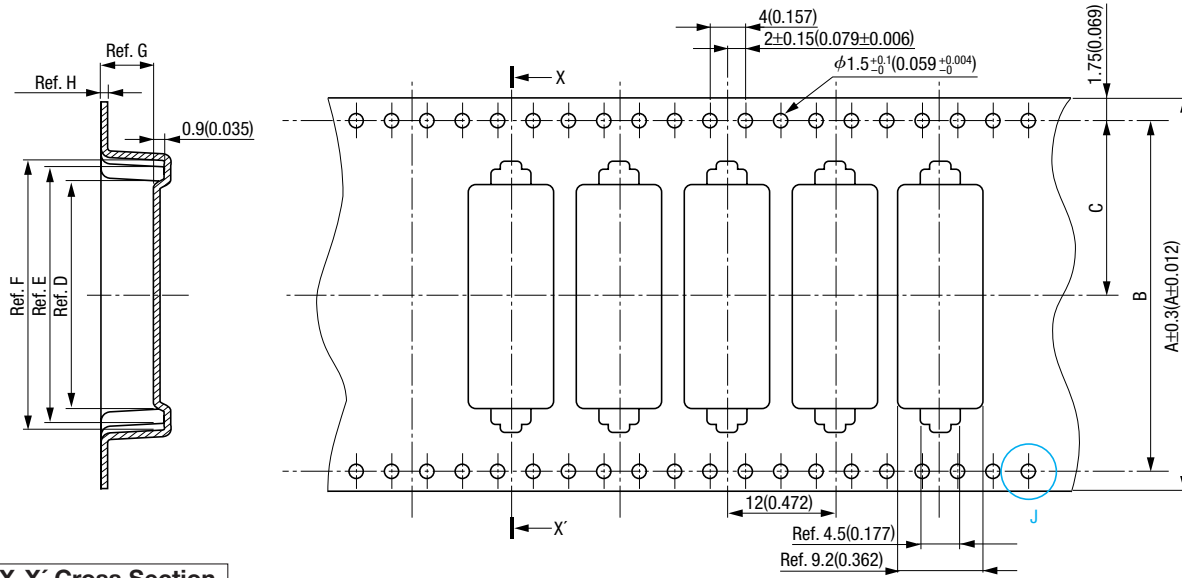

X-X' Cross Section

Reel

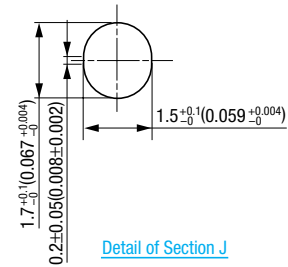
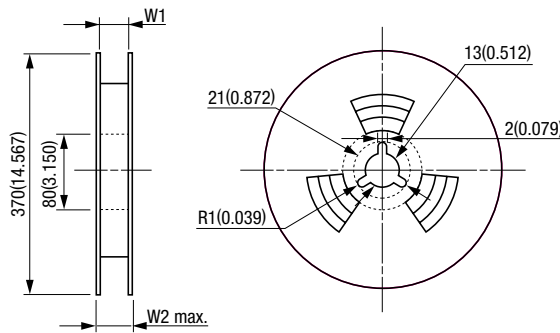

Detail of Section J

Product Table / Dimensions

No. of contacts	Part Number	A	B	C	D	E	F	W1	W2
40	DG01□□-040-□□□□	32.00 (1.260)	28.40 (1.118)	14.20 (0.559)	10.28 (0.405)	13.52 (0.532)	15.14 (0.596)	32.40 (1.276)	38.40 (1.512)
50	DG01□□-050-□□□□	32.00 (1.260)	28.40 (1.118)	14.20 (0.559)	12.78 (0.503)	16.02 (0.631)	17.64 (0.694)	32.40 (1.276)	38.40 (1.512)
60	DG01□□-060-□□□□	32.00 (1.260)	28.40 (1.118)	14.20 (0.559)	15.28 (0.602)	18.52 (0.729)	20.14 (0.793)	32.40 (1.276)	38.40 (1.512)
80	DG01□□-080-□□□□	44.00 (1.732)	40.40 (1.591)	20.20 (0.795)	20.28 (0.798)	23.52 (0.926)	25.14 (0.990)	44.40 (1.748)	50.40 (1.984)
100	DG01□□-100-□□□□	44.00 (1.732)	40.40 (1.591)	20.20 (0.795)	25.28 (1.123)	28.52 (1.187)	30.14 (1.187)	44.40 (1.748)	50.40 (1.984)
120	DG01□□-120-□□□□	56.00 (2.205)	52.40 (2.063)	26.20 (1.031)	30.28 (1.192)	33.52 (1.320)	35.14 (1.383)	56.40 (2.220)	62.40 (2.457)
140	DG01□□-140-□□□□	56.00 (2.205)	52.40 (2.063)	26.20 (1.031)	35.28 (1.389)	38.52 (1.517)	40.14 (1.580)	56.40 (2.220)	62.40 (2.457)
160	DG01□□-160-□□□□	56.00 (2.205)	52.40 (2.063)	26.20 (1.031)	40.30 (1.587)	43.52 (1.713)	45.20 (1.780)	56.40 (2.220)	62.40 (2.457)

Part Number	G	H
DG01MS-160-2□□□	3.10 (0.122)	0.5 (0.020)
DG01MS-160-4□□□	5.10 (0.201)	0.5 (0.020)
DG01MS-□□□-2□□□	3.82 (0.150)	0.4 (0.016)
DG01MS-□□□-4□□□	4.82 (0.190)	0.4 (0.016)
DG01FS-160-2□□□	3.10 (0.122)	0.5 (0.020)
DG01FS-160-3□□□	4.10 (0.161)	0.5 (0.020)
DG01FS-160-4□□□	5.10 (0.201)	0.5 (0.020)
DG01FS-□□□-2□□□	3.82 (0.150)	0.4 (0.016)
DG01FS-□□□-3□□□	4.82 (0.190)	0.4 (0.016)
DG01FS-□□□-4□□□	5.82 (0.229)	0.4 (0.016)

Recommended Soldering Conditions

- Soldering Iron : 350°C max., 3 seconds max.
- Pulse Heating : 260°C max., 3 seconds max.
(Pre-heating) : 160°C max., 3 seconds max.
- Reflow : IR Reflow
- Stencil thickness for soldering paste : 0.15mm (0.006")

Temperature profile for IR reflow

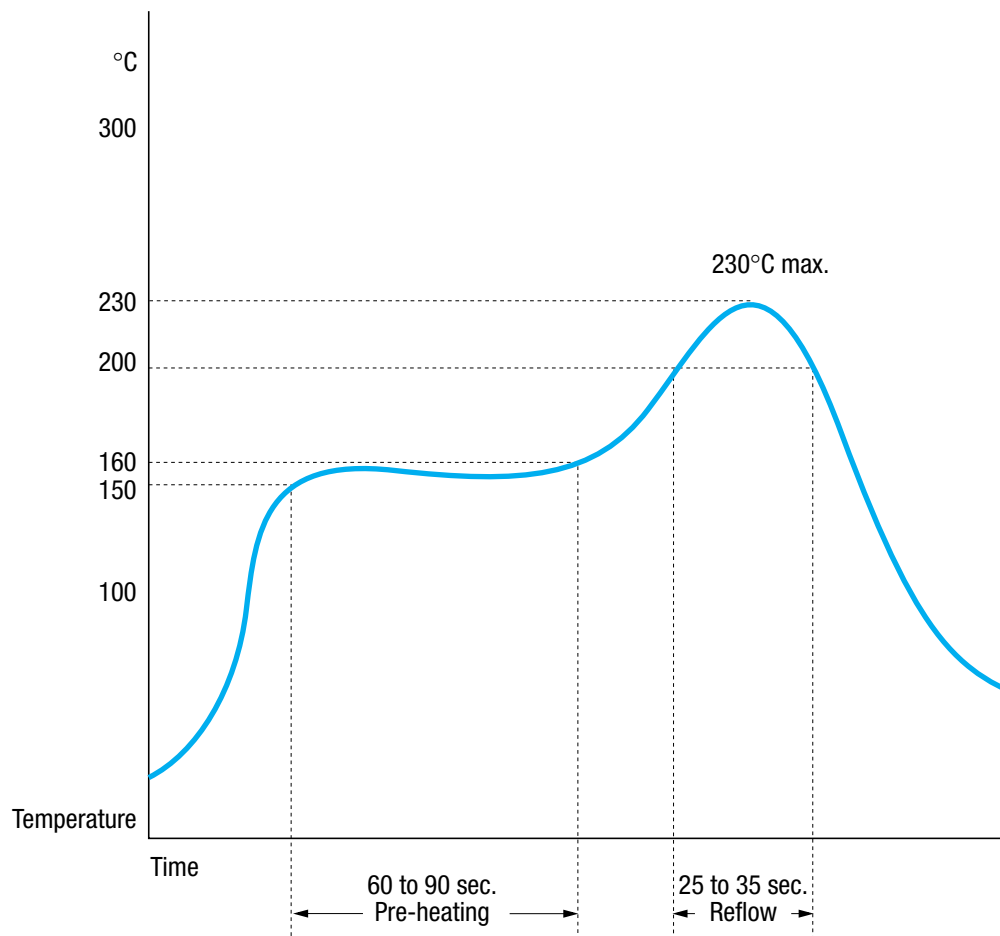

Schareggstrasse 3, CH-5506 Mägenwil
Tel. +41 62 896 00 48, Fax. +41 62 896 25 80
info@admatec.ch, www.admatec.ch